

Dromex



PROTECTION RETRACTABLE FALL ARRESTOR LANYARD BLOCKS



DFA-TPGS06 / DFA-TPGS15

Description

The Dromex® DFA-TPGS06 and DFA-TPGS15 retractable fall arrestor single lanyard systems, allows a user to move freely within a work area, while almost instantly reducing and limiting the free fall hazard as the life line is under tension.

Features:

- The system locks quickly, arresting a fall within inches providing more protection at low heights.
- Robust, durable and nearly indestructible, protective casing with an easy carrying handle.
- Only used in a vertical anchorage (allows movement both horizontally and vertically).
- Fall distance is minimal as compared to energy absorbing lanyards hence retrieval of a fall victim is easier.
- No risk of entanglement when compared to full textile lanyards.
- Reduces the length of the swing during the fall.
- Easily attaches to a full body harness.
- The galvanized steel wire rope (Wire Breaking Strength – 15kN) in encased in a protective snout.
- Has a swivel anchorage eye with a karabiner at anchorage end.
- A swivel steel snap hook with load indicator at harness attachment end.
- A tag line (6m for PN-TPGS06 and 15m for PN-TPGS15) which is attached to the swivel snap hook, is used exclusively for allowing the SRL's line to retract back into the housing during non-use.
- ATEX rated certified - Intrinsically safe for use in potentially explosive environments.

This self-retracting lanyard used with a harness system has a maximum rated load of 140Kg.

Suitable for use when working at heights in the construction (scaffolding, high rope access), refineries, ship building, mining, warehousing and general maintenance industries (window, roof cleaning, painting).

Special Instructions

- Please retain your information booked enclosed in the packaging as it contains your lanyard certification and inspection schedule, required for re-certification and daily inspections. You can also scan the QR code marked on your self retracting lanyard to obtain a copy of the product certification.
- It is recommended that this retractable fall arrestor lanyard should be the personal property of its user and care must be taken to ensure the safety of its user.
- It is essential to verify that the medical condition of the user is fit to use the product in normal and emergency use.
- If using as part of fall arrest system, a suitable anchor point (above the user's head, at least 12 kN) shall be used. Attachments to the anchor points and other equipment shall be made using oval Karabiners conforming to EN 362. The equipment is to be used specifically in a vertical condition.
- It is essential to verify that a minimum 4ms height of free space is available below the user's feet and the ground level at the work place, so that in case of a fall, there will be no collision with the ground or other obstacle in the fall path.
- The following conditions may be hazardous and may affect the performance of Retractable Fall Arrestor:
 - Ageing due to extreme temperatures, cold, heat, moisture and direct sunlight.
 - Deterioration due to chemicals such as oils, acids, solvents and sea water.
 - Inappropriate combination with other equipment.
 - Trailing or looping of lanyards over sharp edges.
 - Extreme acidic or basic environments.
 - Abrasive or sharp edge structures which can damage the equipment.
 - Pendulum falls
 - Use by a person lacking sufficient safety awareness and improper use by untrained persons.
 - Unnecessary physical loading (static or dynamic).
 - Deterioration through mechanical wear, water or staining.
 - Inappropriate storage, maintenance or cleaning.
- Ensure before and during use that a rescue plan is in place to rescue the user after a fall has occurred.
- This fall arrestor, when used as a component of a fall arrest system guarantees the full ability for the safe arresting of a fall from a height by reducing the breaking force measured at the anchorage point or the anchorage line to less than 6.0 kN. It can be used in conjunction with a full body harness
- Do not use the Fall Arrestor as a fall arrest component directly. It is to be used only as a connecting element.
- Please do not add any lanyard / connector as it can increase the distance from fall arrestor to user connection point. This can lead to product failure and can cause serious injury or even death. Users must know how to use a harness with a fixed lanyard attachment.
- However users are advised to use the lanyard with utmost care and the total weight (including all tools) must not be more than 140kg.

- The strength of the anchor device should be greater than 18kN (for Textile) and 12kN (for Metal) and the anchor point should be situated above the user's head.
- Connect the lanyard to the anchorage point using the connector provided at one end. (If a connector is not provided, use karabiners complying to EN 362:2004). The other end on the side of the energy absorber should be connected to the attachment element of the full body harness.
- To optimize protection, in some instances it may be necessary to use the lanyard with suitable other components. In this case before carrying out the risk application related activity, consult your supplier to ensure that all components are compatible and suitable for your application.
- The arrest distance should be double the total length of the lanyard plus 1.75m break distance to allow tearing of the webbing inside.
- Always remember that no item of PPE can provide full protection and care must always be taken while carrying out the risk related activity.
- Only competent users who have received training should use this equipment. (Refer to the SABS/EN recommendations concerning selection, use and maintenance.)
- The manufacturer's instructions must be followed.
- Inspect the equipment before every use to ensure that it is in a serviceable condition and operates correctly as intended.
- Inspect all the rope or webbing of product for cuts/abrasion marks. Also check all connectors of the product for proper mechanical functioning and effects of corrosion or mechanical deformation if any on parts of the connectors in the product.
- Since this lanyard is made of polymers, the performance of which gets affected by temperatures, effect of sharp edges, electrical conductivity, chemical reagents, cutting, abrasion, UV degradation etc, it is advised to consult your supplier for use in the above extreme conditions.
- Ensure that the webbing does not come into contact with high temperature surfaces, welding, heat sources, electrical hazards or moving machinery.
- If the harness and fall arrestor has been involved in arresting a fall, it must be removed from service immediately and destroyed. Withdraw from use the product for which any doubt arises about its condition for safe use.
- Do not make any alterations or additions to the Retractable Fall Arrestor without the manufacturer's prior written consent and that any repair shall only be carried out by personnel trained by the manufacturer & duly authorized by him.
- Ensure that the Retractable Fall Arrestor is compatible with other items when assembled into a system.
- Usage with other un-compatible items may be dangerous & hazardous as the safe function of one item may be affected or interferes with the safe function of another.
- Specially designed harnesses and lanyards with high heat webbing are available for specialized heat applications.
- If the equipment is used in areas, or comes into contact with hazardous chemicals e.g. cleaning materials or atmospheres that may cause damage to the product, contact the manufacturer to see if it is still fit for use.
- If the lanyard is used in a fall arrest system, it is advisable to connect only to the dorsal attachment D-Ring of the harness.

**Dromex: 30 Umganu Road, Flanders, Blackburn
Cornubia Ridge Logistics Park, Kwazulu-Natal, 4319, South Africa
T. +27(31) 713 1960 E. info@dromex.co.za www.dromex.co.za**

Disclaimer

Dromex reserves the right to make changes without further notice to any products herein to improve function, design or reliability and validity. Dromex does not assume any liability arising out of the application or use of any product described herein. Reproduction in whole or in part is prohibited without the prior written consent of the copyright owner.

Latest update: 16/04/2024

- If lanyard is used in fall arrest system, it is essential for safety that the anchor device or anchor point is always positioned, and the work carried out in such a way, as to minimize both the potential for falls and potential fall distance. Ensure that the anchor point is above the user's head.
- If used within fall arrest systems, it is essential to verify the free space required beneath the user at the work place before each occasion of use, so that, in the case of a fall, there will be no collision with the ground or other obstacles in the fall path. There should be a minimum clearance of 4 meters beneath the feet of the user.
- The equipment shall not be used outside its limitation, or for any purpose other than that for which it is intended.
- The device should be used with appropriate combinations only. The user should not make any combination which compromises safe function of any other devices used in combination or entire fall protection system or rescue system.
- It should not be used in highly acidic or basic environments.
- Protect the equipment from mechanical hazards like sharp edges, tools, exposure to sunlight, ultraviolet degradation both during usage, transportation and storage.
- None of the materials or processes used in the manufacture of these products are known to be harmful to the wearer.
- The manufacturer has examined under the system for ensuring quality of production by means of monitoring and inspection.
- Actual conditions of use cannot be directly simulated in a test environment therefore it is the responsibility of the end user and not the manufacturer or supplier to determine the gloves suitability for the intended use.
- No item of PPE can provide full protection and care must always be taken while carrying out the risk related activity.
- Users are advised to keep the User Instructions document for the life of the product.

Specifications

| | |
|------------------|---|
| Style: | PN-DFA-TPGS06, 6 Meter long, retractable fall arrestor, single lanyard, with swivel anchorage eye, karabiner and a swivel snap hook harness connector and a 6m tag line. PN-DAF-TPGS15, 15 Meter long, retractable fall arrestor, single lanyard with swivel anchorage eye, karabiner and a swivel snap hook harness connector and a 15m tag line. |
| Material casing: | High Impact Strength Polymer Plastic casing. |
| Cable: | Galvanized steel wire rope Ø4.5 (min). |
| Cable cover: | Hardened polymer. |
| Anchorage eye: | Swivel type steel with steel quarter turning lock karabiner. |
| Scews: | Medium carbon steel. |
| Snap hook: | Swivel anodized aluminium anchor with steel hook. |
| Tag-line: | Nylon |
| Weight: | PN- DFA-TPGS06 - 3.000 kg ± 0.10 kg. PN- DAF-TPGS15 - 5.650 kg ± 0.10 kg. |
| Additional: | Fall factor rating is 0, for anchorage use over the head height. |

Compliance & Conformity

• This Retractable Fall Arrestor is classed as a Personal Protective Equipment (PPE) by the European PPE Regulation (EU) 2016/425 and has been shown to comply with this Regulation through the Harmonized European Standards:

- EN 360:2002.- Personal protective equipment against falls from a height. Retractable type fall arresters.
- Atex certified for use in potentially explosive atmosphere as per Directive 2014/34/EU.

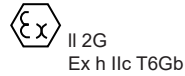

Packaging, Storage & Obsolescence

DFA-TPGS15 is packed in a box and sold individually. Store in a cool dry place, that is clean and ventilated and placed away from direct sunlight and extremes of temperature. Never place heavy items on top of it. If possible, avoid excessive folding and preferably store it hanging vertically. If the product is wet, allow it to dry fully before placing it into storage. It is preferred that the product be transported in its original packing. However, if not available, it may be stored in a polybag which is sealed to prevent moisture.

Cleaning & Maintenance

As with any piece of equipment, self retracting lanyards require care, maintenance and storage to ensure they function properly. In the case of a lanyard, any malfunction could have severe consequences.

- The equipment must be inspected and its condition recorded by a competent person before each use.
- The user's company Safety Officer must maintain a record log of servicing and inspections dates of the unit.
- In case of minor stains, wipe the equipment with a cotton cloth or a soft brush.
- Metallic parts incorporated lanyard should be wiped with a dry cloth.
- Do not use any abrasive material.
- The locking assembly should not be subjected to water.
- For intensive cleaning wash in water at a temperature between 25°C to 50°C, using a neutral detergent (pH7).
- It should be allowed to dry by itself
- Do not use acid or basic detergents.
- Follow the washing instructions without any deviations.
- After cleaning and drying, store the equipment in a dry dark cool position, preferably away from moisture, open fire, direct sunlight or any other source of heat, extra acidic or basic conditions, and sharp edges.
- DO NOT STORE THE EQUIPMENT WET.

Shelf life

All soft goods, including harness, can be used for ten years from the date of first use as long as they are examined by a qualified individual who has been trained by the manufacturer in accordance with EN365 requirements. After ten years OR if it doesn't pass the competent person examination, the product must be taken out of service.

Ensure product storage guidelines are followed.

The following factors can reduce the Lifespan of the product; intense use, contact with chemical substances, especially aggressive environment, extreme temperature exposure, UV exposure, abrasion, cuts, violent impacts, bad use, or maintenance.

Remove and replace if the equipment has arrested a fall.

Instructions to be followed before use

- It is important to carry out a pre use check of the equipment to ensure that it is in a serviceable condition and operates correctly before it is used.
- The pre-use check shall involve checking of any wear or abrasion on the ropes and sign of corrosion, if any on the metal parts or any breakage of the plastic casing.
- In case of any doubt arising about the condition of any component or system, replace it immediately. If the harness has arrested a fall, or if the impact/load indicator has accidentally been deployed during handling, withdraw it from service and return to the manufacturer or a competent repair center.
- Ensure that the strength of the anchor device is greater than 12kN.
- Use a karabiner conforming to EN 362 for connecting to the anchor points.
- It is advisable to use the dorsal attachment D-Ring of the harness for connection to the Retractable Fall Arrestor, however if it is not possible for any reason, the chest attachment element may also be used (specific harness models have this feature).
- Ensure the compliance with recommendations for use as applicable to the combination with other components of the fall arrest system, and specified on the identification card for the fall arrest system or component concerned. Make sure that the connector used (Karabiner) is correctly attached to the loop and that it is locked and conforms to required norm.

**Dromex: 30 Umganu Road, Flanders, Blackburn
Cornubia Ridge Logistics Park, Kwazulu-Natal, 4319, South Africa
T. +27(31) 713 1960 E. info@dromex.co.za www.dromex.co.za**

Disclaimer

Dromex reserves the right to make changes without further notice to any products herein to improve function, design or reliability and validity. Dromex does not assume any liability arising out of the application or use of any product described herein. Reproduction in whole or in part is prohibited without the prior written consent of the copyright owner.

Latest update: 16/04/2024

How to use fall arrestor

STEP 1: Connect the anchorage eye at the top of the Retractable Fall Arrestor to a suitable anchorage point situated above the user's head using Karabiners as per EN 362 & ensure the Karabiner is locked.

STEP 2: Now connect the swivel hook of the equipment to the attachment element of your full body harness and ensure that it is locked. You are now safe to move up & down in normal speed. In the event of a fall, the Retractable Fall Arrestor locks & also minimizes the impact forces on the body of the user.

How a tag line is used

The tag line is attached to the swivel snap hook connector of the retractable fall arrestor



- Unfasten the tag line where it was secured and pull the tag line to lower the fall arrestor retractile rope.
- Remove the tag off the swivel hook of the fall arrestor
- Attach the fall arrestor swivel snap hook onto the harness D ring

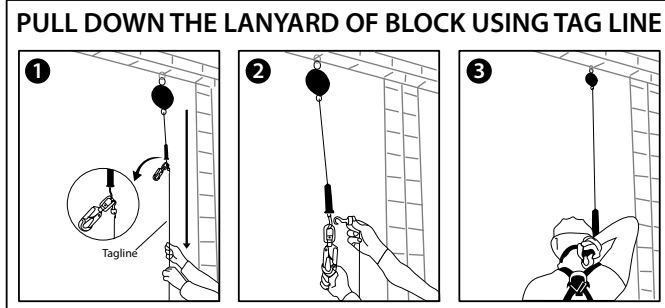

Periodic Examination

- This product needs to be periodically examined because the safety of the user depends upon the continued efficiency and durability of the lanyard.
- It is important to examine it at least once in every 12 months.
- Periodic examination is to be conducted by a competent person and strictly in accordance with the manufacturer's periodic examination procedures.
- Periodic examination also requires checking the legibility of the product markings.
- Always retain a copy of the Harness Equipment Periodic Examination and Repair History checklists.

Drawing

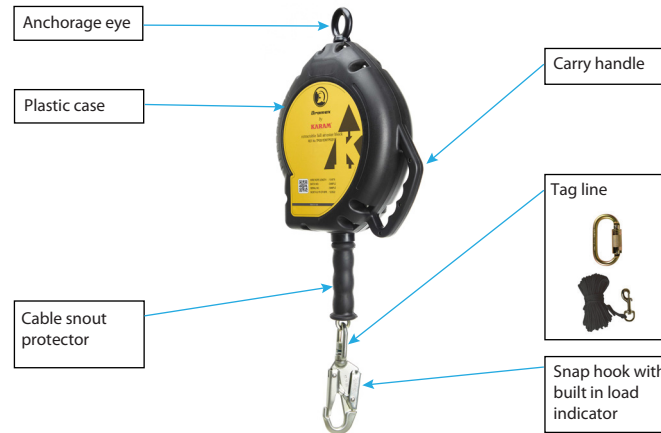

Marking

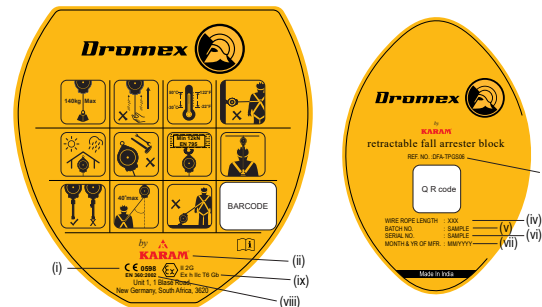

Marking on Product

The Retractable Fall Arrestor is marked with:

- The CE mark showing that the product meets the requirement of the European PPE Regulation (EU) 2016/425
- Identification of the manufacture and address
- Type of product code
- Wire/Rope Length
- Batch/Lot Number
- Serial Number
- Month & Year of Manufacture
- Norm & Year
- Atex marking

Information on Label

This self retracting Lanyard is marked with:

- Keep away from sunlight or heavy rains.
- Ensure that the anchorage point has a strength of min 12kN.
- Ensure that the max angle between the vertical and the lanyard is 40°.
- Ensure that wire rope has no cuts or abrasion marks before use.
- Once the wire rope has been reeled out, do not leave it suddenly to retract inside on its own, let it go inside gradually by guiding it slowly inside.
- Can be used for horizontal applications.
- Connect the lanyard to the Dorsal attachment element of your harness.
- Use between a temperature range of -30°C + 50°C.
- To be used by a person weighing not more than 140kg.
- Do not attempt to repair unless trained by the manufacture.
- Cannot be used at foot level.

Disposal

Industrial self retracting lanyards should be disposed of considering the hazardous substance they were used for, if damaged and once the shock absorber has been deployed. Please consider recycling.

Steps for safe Disposal:

- Segregate the equipment in three different crates for placing components in them respectively such as - Textile, Metal and Plastic.
- Place the fall arrestor on a flat surface/table.
- Inspect the wear and tear present on the lanyard.
- Dismantle the lanyard.
- Thereafter remove the metal & plastic components separately from the lanyard.
- Put the Textile, Plastic & Metal components in their respective plastic crates.
- Once segregation done, arrange to send them for recycling (as appropriate) through authorized agencies as per local or national law.

**Dromex: 30 Umganu Road, Flanders, Blackburn
Cornubia Ridge Logistics Park, Kwazulu-Natal, 4319, South Africa
T. +27(31) 713 1960 E. info@dromex.co.za www.dromex.co.za**